

E-mail: [kk@keyknife.com](mailto:kk@keyknife.com)  
Web site: [www.keyknife.com](http://www.keyknife.com)

**Key Knife, Inc.**  
19100 S.W. 125th Court  
Tualatin, OR 97062, USA  
Phone: (503) 403-2000  
Fax: (503) 691-2240

**Northern U.S.**  
19100 S.W. 125th Court  
Tualatin, OR 97062, USA  
Phone: (503) 403-2000  
Fax: (503) 691-2240

**Southern U.S.**  
2305F HWY 378  
Conway, SC 29527, USA  
Phone: (800) 280-0033  
Fax: (843) 397-7787

**Western U.S.**  
19100 S.W. 125th Court  
Tualatin, OR 97062, USA  
Phone: (503) 403-2000  
Fax: (503) 691-2240

**Key Knife South Pacific  
Pty Ltd**  
Unit 4 / 26 Isles Drive  
Coffs Harbour NSW 2450  
Australia  
Phone: 61-2-6651-8123  
Fax: 61-2-6651-8133

**Western Canada**  
2740 Burrard Street  
Vanderhoof, B.C. V0J 3A0  
Canada  
Phone: (250) 567-2447  
Fax: (250) 567-2468

**Eastern Canada**  
16 J.F. Kennedy Suite 600  
St. Jerome, Quebec J7Y 4B6  
Canada  
Phone: (800) 989-3739  
Fax: (450) 438-5757

**Key Knife Europe**  
Weyrerstrasse 102  
A-3340 Waidhofen  
Austria  
Phone: ++43-74-42-53-35-0  
Fax: ++43-74-42-53-35-0-33



Key Knife identified the need for a new planer head that would help planer mills increase production, lower production costs, improve finish, and enhance employee safety. Key Knife used their extensive knowledge of indexible knife technology to create the revolutionary Key Planer Head.

The innovative design of the planer head and the use of a smaller disposable knife allows for more knives in a cutting diameter. The result is a planer head that will significantly improve your surface finish, production volume, operating efficiencies, and safety.





# KEY PLANER HEAD



**INCREASED PRODUCTION**

The Key Planer Head utilizes more knives in a cutting diameter than any other head available. This important feature alone significantly increases the number of cuts per inch made. This benefits your operation by giving you the flexibility to increase the production rate without sacrificing finish. Also, by increasing the production rate you will produce more quality lumber for less money. Additional gains in production are achieved through longer knife life and faster knife changes. By minimizing planer downtime due to knife changes you will increase your production volume.



**SUPERIOR SURFACE FINISH**

The Key Planer Head improves the value of your lumber by producing a finish second to none. By increasing the number of knives in the Key Planer Head's cutting diameter (in some cases by as much as 100%) we can significantly increase the number of cuts per inch made. You now have the flexibility to either increase both production and surface finish, or simply maintain your feed speed and dramatically improve surface finish.



**INCREASED OPERATING EFFICIENCY AND SAFETY**

Each Key Planer part was value engineered to ensure the system is easy to maintain and safe to operate. For example, the Ridge Strip Planer Knife is precision ground from modified tool steel. The result is a dual edged knife that eliminates the need for grinding, lasts 2-3 times longer than a conventional knife, and does not need to be kept in matched sets. Also, the smaller knife is easier to handle and has two small ridges that locate on grooves in each pocket for quick and safe knife changes.

**ADVANCED GULLET SHAPE**

- Allows for shavings to exit quickly
- Eliminates chip marks



**DISPOSABLE KNIFE**

- Two edges last 2-3 times longer than conventional knives. Eliminates the need for grinding and weighing/matching knife sets.

**TAPER LOCKING GIB SCREW**

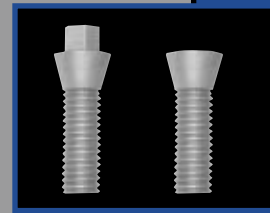

The gib screw provides the clamping force and wedging effect to hold the knife in position. The gib screw is ideally positioned perpendicular to the center of the shaft to ensure proper placement of the knife, and eliminate the need to torque the gib screws in a pattern. 2 gib screw styles are available - socket head and hex head.

**RIDGE STRIP PLANER KNIFE**



Made from modified tool steel for exceptional knife life. Two precision ground edges last 2 to 3 times longer than conventional knives. The knife is indexible and disposable eliminating the need for grinding and weighing/matching knife sets. Two ridges on the bottom of the knife locate on the gib for exact knife placement, eliminating the need for "rolling in the knives".

**TAPER LOCKING GIB SCREW**

- Easily accessible for safe unlocking.



**I-Knife**

- Available for both dry and green target sizes.
- Available Radius sizes: 1/8" - 3/16" - 1/4"

**INNOVATIVE HEAD DESIGN**

- Allows for up to 100% more knives in the same cutting diameter as a conventional planer head.

**AVAILABLE MOUNTING CONFIGURATIONS:**

- Standard Taper Bore
- Hydro-Lock
- Hub Sleeve

**GIB**



Manufactured out of chipper steel for strength, durability, and wear resistance. The gib is manufactured to tight dimensional weight tolerances, eliminating the need to weigh/match gib sets. The smooth and open gullet design reduces wear on the gib, and allows for planer shavings to efficiently exit the system.

**HUB and SHAFT**



Precision machined from high grade alloy steel and balanced to ISO G1.0 spec to minimize vibration. The innovative design allows for up to 100% more knives in the same cutting diameter as a conventional planer head. The Key Planer Head is available for both integral and hydrolock arbor clamping systems.

**SINGLE GIB/GIB SCREW DESIGN**

- Allows for quick and easy knife change and setup.

**DISPOSABLE KNIFE**

- 2 edges last 3 to 5 times longer than conventional knives. Eliminates the need for grinding and weighing/matching knife sets.

